



DATA DISPLAY GROUP

# DATASHEET

## 48.3cm (19") POS-LINE MONITOR

[www.datadisplay-group.com](http://www.datadisplay-group.com)

Robust industrial monitor with 19" (48.3 cm) display and various options for controller, PCs, bezels, glasses and touch.

- Open frame or desktop
- Bezel for front installation
- High quality LCD panel with LED backlight
- Touch technologie
- Video controller, integrated PC or media player
- TrueFlat glass, safety glass
- Portrait or landscape
- VESA or mounting brackets
- Aluminium chassis
- IP protected
- Screw terminal for power supply



## Panel and housing

Panel Diagonal	[mm] / [Inch]	483/ 19
Type		Open -frame monitor with 2 mounting brackets (various bezels, true-flat glass and touch solutions are available under options)
Resolution	[Pixel]	1280 x 1024
Luminance (center)	[cd/m <sup>2</sup> ]	300
Viewing angle	[°]	178 h / 178 v
Backlight		LED
Active area (H/V)	[mm]	376.32 x 301.06
Number of colors	[M]	16.7
Contrast ratio		2000:1
Response time (on/off)	[ms]	35
Pixel class		ISO 9241-307 (pixel error class II)
Life time back light	[h]	50.000
Mounting	[mm]	VESA 200 x 100
Storage temperature	[°C] / [°F]	-20 ~ 60 / -4 ~ 140
Operating humidity	[%]	8 ~ 90 (non condensing)
Panel orientation		Landscape and Portrait
Location of connectors		Landscape: bottom Portrait: left (front view)
Location of OSD buttons		Landscape: top Portrait: right (front view)
Housing		Powdered Aluminium, black RAL 9005
Conformity		CE, FCC Class A, EU-RoHS

## POS-Line 19"



Open frame monitor including two standard brackets and all possible optional mounting brackets

# VGA, HDMI, DisplayPort

## POS-Line 19" Video PME

Order number		DS-91-781
Interfaces		1 x VGA, 1 x HDMI, 1 x DisplayPort, 1 x Audio Line-Out, 1 x USB-Remote
Operating temperature	[°C/ F°]	0 ~ 50/ 32 ~ 122
Power supply	[V]	12
Power consumption (typ.)	[Watt]	21
Weight	[kg/ lb]	3.2/ 4.85
Dimensions (W x H x D)	[mm/ inch]	412.0 x 340.0 x 55.5 13.13 x 10.45 x 2.01

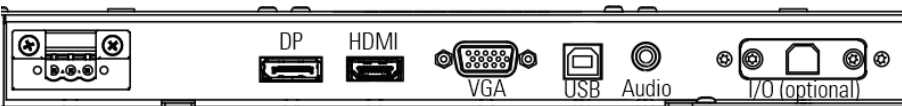

# Network Mediaplayer

## POS-Line 19" VideoPoster

Order number		DS-91-782
Interfaces		1 x LAN, 1 x USB, 1 x HDMI, 1 x Line out, 1 x Line in, 1 x SD card slot
Operating temperature	[°C/ F°]	0 ~ 45/ 32 ~ 113
Power supply	[V]	12
Power consumption (typ.)	[Watt]	29
Weight	[kg/ lb]	3.3/ 5.07
Dimensions (W x H x D)	[mm/ inch]	412.0 x 340.0 x 55.5 13.13 x 10.45 x 2.01

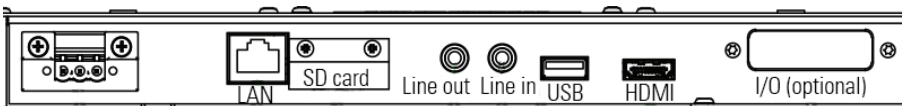

# PC Intel Atom



## POS-Line 19" IQ Atom

Order number		DS-91-780
Interfaces		2 x Gigabit LAN, 1 x USB 3.0, 1 x USB 2.0, 1 x HDMI, 1 x VGA, 1 x RS232/422/485, 1 x RS232 (optional)
PC		CPU: Intel® Atom E3845 (1.9 GHz), RAM: 4 GB DDR3L, Storage: min. 120 GB mSATA
Fan		no
Operating temperature	[°C/ F°]	0 ~ 45/ 32 ~ 113
Power supply	[V]	12 - 26
Power consumption (typ.)	[Watt]	33
Weight	[kg/ lb]	3.3/ 4.85
Dimensions (W x H x D)	[mm/ inch]	412.0 x 340.0 x 55.5 13.13 x 10.45 x 2.01



# PC Intel Core-i

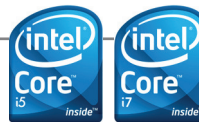

## POS-Line 19" IQ Core-i

Order number		DS-91-778	DS-91-779
Core-i		i5	i7
Interfaces		2 x Gigabit LAN, 2 x USB 3.0, 1 x DVI, 1 x RS232/422/485, 1 x RS232 (optional)	
PC		CPU: Intel® Core-i5-4300U (1.9 GHz) RAM: 4GB DDR 3L Storage: min. 120 GB mSATA	CPU: Intel® Core-i7-4650U (1.7 GHz) RAM: 4GB DDR 3L Storage: min. 120 GB mSATA
Fan		no	
Operating temperature	[°C/ F°]	0 ~ 45/ 32 ~ 113	
Power supply	[V]	12 - 24	
Power consumption (typ.)	[Watt]	41	45
Weight	[kg/ lb]	3.6/ 5.51	
Dimensions (W x H x D)	[mm/ inch]	412.0 x 340.0 x 76.3 13.13 x 10.45 x 2.83	

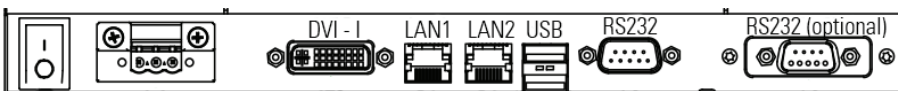



## Glass\*

Order number		DS-90-196	DS-91-756
Name		Safety glass	TrueFlat glass
Glass		Safety glass TSG, 3 mm anti glare	Safety glass TSG, 3 mm anti glare, printed black passepartout
Can be combined with		Front bezel, Front plate	—
IP protection	front/ rear	IP 64 (in combination with bezel or plate)/ IP 20	IP 65/ IP 20
Weight	[kg/ lb]	0.80/ 1.76	1.50/ 3.30
Dimensions of monitor with option (W x H x D)	[mm/ inch]	412.0 x 340.0 x 55.5 13.13 x 10.45 x 2.01	454.0 x 382.0 x 61.5 14.70 x 11.87 x 2.24

## Touches\*

Order number		DS-91-795
Name		Resistive touch
Glass		Safety glass TSG, 2.2 mm anti glare
Touch points		1
Touch technology		5-wire analogue resistive
Can be combined with		Front bezel, Front plate
IP protection	front/ rear	IP 64 (in combination with bezel or plate)/ IP 20
Available for controller		Video PME, IQ Atom, IQ Core-i
Weight	[kg/ lb]	0.60/ 1.32
Dimensions of monitor with option (W x H x D)	[mm/ inch]	412.0 x 340.0 x 55.5 13.13 x 10.45 x 2.01

## Bezel/ Plate

Order number		DS-91-325	DS-91-751
Name		Front bezel	Front plate
Finish		Steel, powdered, black RAL 9005	Aluminum, powdered, black RAL 9005
Can be combined with		Resistive touch, Safety glass	
IP protection	front/ rear	IP64 (in combination with glass/ touch) otherw. IP20/ IP20	
Weight	[kg/ lb]	0.50/ 1.10	0.60/ 1.32
Dimensions of monitor with option (W x H x D)	[mm/ inch]	415.0 x 343.0 x 57.0 13.24 x 10.57 x 2.07	454.0 x 382.0 x 60.4 14.70 x 11.87 x 2.19

## Options



**Safety glass** and touch are options for the open frame chassis. It covers and protects the TFT-panel.



**TrueFlat glass** is a safety glass with round corners and passepartout for the open frame chassis.

\*Cover glass and touches will reduce monitor brightness.



**Front bezel** is a metal bezel for the open frame chassis and VESA mount.



**Front plate** is a metal frame for front mount applications with mounting brackets.

## Rackmount

Order number		DS-91-792
Name		Front plate rackmount
Finish		Steel, powdered, black RAL 9005
Can be combined with		Resistive touch, Safety glass
IP protection	front/ rear	IP64 (in combination with glass/ touch) otherw. IP20/ IP 20
Weight	[kg/ lb]	0.8/ 1.76
Dimensions of monitor with option (W x H x D)	[mm/ inch]	482.6 x 400.0 x 99 19.0 x 15.75 x 3.90

## Mounting/ WLAN/ Bluetooth

Order number	DS-91-706	
Name	WLAN/ Bluetooth module	
Description	WLAN module with external antenna Bluetooth module without external antenna	
WLAN	Intel Centrino Wireless N2230/ IEEE WLAN Standard: 802.11b/g/n up to 300 Mbps/ 2.4 GHz/ Safety: WPA (TKIP)/ WPA2 (AES-CCMP)	
Bluetooth	Dual Mode Bluetooth 4.0 (low energy) 2.1, 2.1+EDR, 3.0, 3.0+HS, 4.0 (BLE)	
Can be combined with	with all front options	
Available for controller	IQ Atom, IQ Core-i	

Order number	DS-91-797	DS-91-356
Name	VESA adapter plate	Mounting brackets
Description	Adaption from VESA 200 x 100 to VESA 100 x 100	Set of two additional mounting brackets
Can be combined with	with all front options	Open frame, front plate, safety glass, TueFlat glass, Touch
Available for controller	all	

## Power supply

Order number	NT-01-060	NT-01-061
Name	Power supply 60 W	Power supply 84 W
Description	12V/ 5A power supply max. op. temperature 45°C	12V/ 7A power supply max. op. temperature 40°C
Can be combined with	Video PME, VideoPoster, IQ Atom	Core-i5, Core-i7
Power cord EU 1,8 m	DB-07-225	
Power cord UK 1,8 m	DB-07-226	
Power cord USA 1,8 m	DB-07-238	

## Options



## Accessories

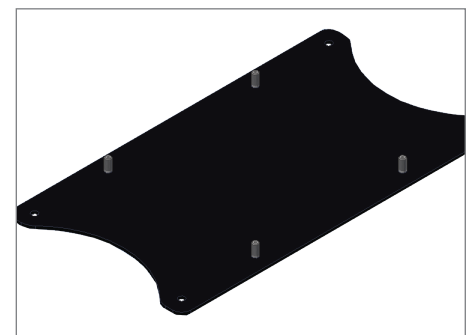
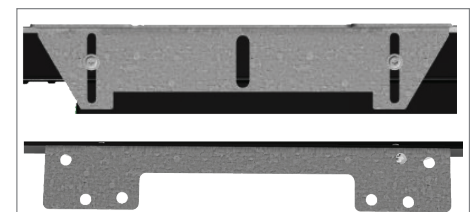

## Operating systems, Software

Product	Order no.	Product description
Windows 7 embedded 32 bit DE	DS-60-645	Operation system
Windows 7 embedded 32 bit EN	DS-60-650	Operation system
Windows 7 FES 64 bit DE	DS-60-725	Operation system
Windows 7 FES 64 bit EN	DS-60-781	Operation system
Windows 8.1 embedded 64 bit DE	DS-60-764	Operation system
Windows 10 Pro. 64 bit DE	DS-60-811	Operation system
Windows 10 Pro. 64 bit EN	DS-60-810	Operation system
WEBPOStER	DS-60-787	WEBPOStER embedded Linux

Various accessories are available for POS-Line monitors.

All monitors can be customized according to your specific requirements.

Please contact our sales team if you are interested in product modifications or custom designs.

## Data Display Group



DATA Display Group is represented through its own subsidiaries in Germany, the USA and England. Please address all enquiries to the office nearest to you. For sales or service matters we will either handle your enquiry directly, or invite you to contact one of our business partners in your area for assistance.

Distec GmbH  
Augsburger Str. 2b  
82110 Germering

+49 89 894363-0  
 [info@datadisplay-group.de](mailto:info@datadisplay-group.de)  
 [www.datadisplay-group.de](http://www.datadisplay-group.de)

Distec GmbH  
Am Künkelhof 4  
99820 Hørselberg-Hainich

+49 3 69 20 71 62-0

Display Technology Ltd.  
5 The Oaks Business Village  
Revenge Road, Lordswood  
Chatham, Kent, ME5 8LF

+44 1634 672755  
 [info@displaytechnology.co.uk](mailto:info@displaytechnology.co.uk)  
 [www.displaytechnology.co.uk](http://www.displaytechnology.co.uk)

Apollo Display Technologies, Corp.  
87 Raynor Avenue, Unit 1  
Ronkonkoma, NY 11779

+1 631 5804360  
 [info@apolloDisplays.com](mailto:info@apolloDisplays.com)  
 [www.apolloDisplays.com](http://www.apolloDisplays.com)

## Contact



All figures are typical values. The real values of the panel may vary. The optical characteristics are determined after the panel has been „ON“ for approximately 30 minutes at an ambient temperature of 25° C (77° F).

Life time of the backlight is defined as the time to take until the brightness reduces to 50% of its original value.

Copyright 2016 Data Display Group. Information in the document is subject to change without prior notice.