

DATA DISPLAY GROUP

DATASHEET

43.8 cm (17.3") POS-LINE MONITOR

www.datadisplay-group.com

Robust industrial monitor with 17.3" (43.8 cm) full-hd display and various options for controller, PCs, bezels, glasses and touch.

- Open frame or desktop
- Bezel for front installation
- High quality LCD panel with LED backlight
- PCAP touch technologie
- Video controller, integrated PC or media player
- TrueFlat glass, safety glass
- Portrait or landscape
- VESA or mounting brackets
- Aluminium chassis
- IP protected
- Screw terminal for power supply



Panel and housing

Panel Diagonal	[mm] / [Inch]	438.2/ 17.3
Type		Open -frame monitor with 2 mounting brackets (various bezels, true-flat glass and touch solutions are available under options)
Resolution	[Pixel]	1920 x 1080 FHD
Luminance (center)	[cd/m ²]	400
Viewing angle	[°]	160 h / 140 v
Backlight		LED
Active area (H/V)	[mm]	381.88 x 214.81
Number of colors	[M]	16.7
Contrast ratio		600:1
Response time (on/off)	[ms]	40
Pixel class		ISO 9241-307 (pixel error class II)
Life time back light	[h]	50.000
Mounting	[mm]	VESA 200 x 100
Storage temperature	[°C] / [°F]	-20 ~ 70 / -4 ~ 158
Operating humidity	[%]	10 ~ 90 (non condensing)
Panel orientation		Landscape and Portrait
Location of connectors		Landscape: bottom Portrait: left (front view)
Location of OSD buttons		Landscape: top Portrait: right (front view)
Housing		Powdered Aluminium, black RAL 9005
Conformity		CE, FCC Class A, EU-RoHS

POS-Line 17.3"

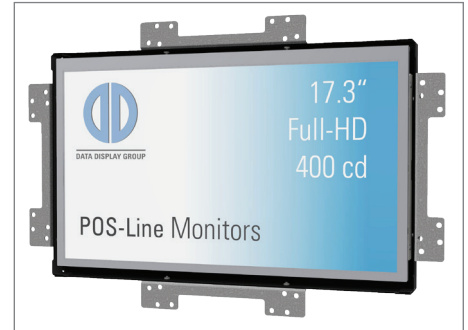

Open frame monitor including two standard brackets and all possible optional mounting brackets

VGA, HDMI, DisplayPort

POS-Line 17.3" Video PME

Order number		DS-91-776
Interfaces		1 x VGA, 1 x HDMI, 1 x DisplayPort, 1 x Audio Line-Out, 1 x USB-Remote
Operating temperature	[°C/ F°]	0 ~ 50/ 32 ~ 122
Power supply	[V]	12
Power consumption (typ.)	[Watt]	15
Weight	[kg/ lb]	2.4/ 5.29
Dimensions (W x H x D)	[mm/ inch]	416.6 x 259.2 x 52.5 16.40 x 10.20 x 2.07

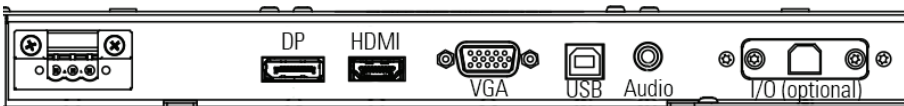

Network Mediaplayer

POS-Line 17.3" VideoPoster

Order number		DS-91-777
Interfaces		1 x LAN, 1 x USB, 1 x HDMI, 1 x Line out, 1 x Line in, 1 x SD card slot
Operating temperature	[°C/ F°]	0 ~ 45/ 32 ~ 113
Power supply	[V]	12
Power consumption (typ.)	[Watt]	22
Weight	[kg/ lb]	2.5/ 5.51
Dimensions (W x H x D)	[mm/ inch]	416.6 x 259.2 x 52.5 16.40 x 10.20 x 2.07

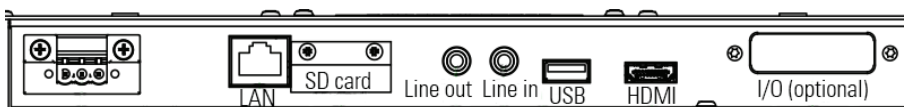

PC Intel Atom



POS-Line 17.3" IQ Atom

Order number		DS-91-775
Interfaces		2 x Gigabit LAN, 1 x USB 3.0, 1 x USB 2.0, 1 x HDMI, 1 x VGA, 1 x RS232/422/485, 1 x RS232 (optional)
PC		CPU: Intel® Atom E3845 (1.9 GHz), RAM: 4 GB DDR3L, Storage: min. 120 GB mSATA
Fan		no
Operating temperature	[°C/ F°]	0 ~ 45/ 32 ~ 113
Power supply	[V]	12 - 26
Power consumption (typ.)	[Watt]	27
Weight	[kg/ lb]	2.4/ 5.29
Dimensions (W x H x D)	[mm/ inch]	416.6 x 259.2 x 52.5 16.40 x 10.20 x 2.07



PC Intel Core-i

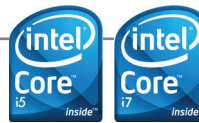

POS-Line 17.3" IQ Core-i

Order number		DS-91-773	DS-91-774
Core-i		i5	i7
Interfaces		2 x Gigabit LAN, 2 x USB 3.0, 1 x DVI, 1 x RS232/422/485, 1 x RS232 (optional)	
PC		CPU: Intel® Core-i5-4300U (1.9 GHz) RAM: 4GB DDR 3L Storage: min. 120 GB mSATA	CPU: Intel® Core-i7-4650U (1.7 GHz) RAM: 4GB DDR 3L Storage: min. 120 GB mSATA
Fan		no	
Operating temperature	[°C/ F°]	0 ~ 40/ 32 ~ 104	
Power supply	[V]	12 - 24	
Power consumption (typ.)	[Watt]	45	51
Weight	[kg/ lb]	2.7/ 5.95	
Dimensions (W x H x D)	[mm/ inch]	416.6 x 259.2 x 73.3 16.40 x 10.20 x 2.88	

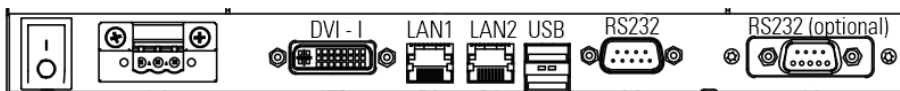

Glass*

Order number		DS-91-596	DS-91-755
Name		Safety glass	TrueFlat glass
Glass		Safety glass TSG, 3 mm anti glare	Safety glass TSG, 3 mm anti glare, printed black passepartout
Can be combined with		Front bezel, Front plate	—
IP protection	front/ rear	IP 64 (in combination with bezel or plate)/ IP 20	IP 65/ IP 20
Weight	[kg/ lb]	0.8/ 1.76	1.30/ 2.87
Dimensions of monitor with option (W x H x D)	[mm/ inch]	416.6 x 259.2 x 52.5 16.40 x 10.20 x 2.07	456.6 x 299.2 x 58.5 17.98 x 11.78 x 2.30

Touches*

Order number		DS-91-760	DS-91-759
Name		PCAP touch	TrueFlat PCAP touch
Glass		Safety glass TSG, 3 mm anti glare	
Touch points		10	
Touch technology		Projected capacitive	
Can be combined with		Front bezel, Front plate	—
IP protection	front/ rear	IP 64 (in combination with bezel or plate)/ IP 20	IP 65/ IP 20
Available for controller		Video PME, IQ Atom, IQ Core-i	
Weight	[kg/ lb]	0.8/ 1.76	1.30/ 2.87
Dimensions of monitor with option (W x H x D)	[mm/ inch]	416.6 x 259.2 x 52.5 16.40 x 10.20 x 2.07	456.6 x 299.2 x 58.5 17.98 x 11.78 x 2.30

Bezel/ Plate

Order number		DS-91-793	DS-91-750
Name		Front bezel	Front plate
Finish		Steel, powdered, black RAL 9005	Aluminum, powdered, black RAL 9005
Can be combined with		PCAP touch, Safety glass	
IP protection	front/ rear	IP64 (in combination with glass/ touch) otherw. IP20/ IP 20	
Weight	[kg/ lb]	0.5/ 1.10	
Dimensions of monitor with option (W x H x D)	[mm/ inch]	419.6 x 262.2 x 54 16.52 x 10.32 x 2.12	456.6 x 299.2 x 57.2 17.98 x 11.78 x 2.25

Options



Safety glass and touch are options for the open frame chassis. It covers and protects the TFT-panel.



TrueFlat glass is a safety glass with round corners and passepartout for the open frame chassis.

TrueFlat P-CAP touch is a TrueFlat glass with a laminated P-CAP touch at the backside.

*Cover glass and touches will reduce monitor brightness.



Front bezel is a metal bezel for the open frame chassis and VESA mount.



Front plate is a metal frame for front mount applications with mounting brackets.

Rackmount

Order number		DS-91-791
Name		Front plate rackmount
Finish		Steel, powdered, black RAL 9005
Can be combined with		PCAP touch, Safety glass
IP protection	front/ rear	IP64 (in combination with glass/ touch) otherw. IP20/ IP 20
Weight	[kg/ lb]	0.6/ 1.32
Dimensions of monitor with option (W x H x D)	[mm/ inch]	482.6 x 311.2 x 96 19.0 x 12.25 x 3.78

Options



Mounting/ WLAN/ Bluetooth

Order number	DS-91-706	
Name	WLAN/ Bluetooth module	
Description	WLAN module with external antenna Bluetooth module without external antenna	
WLAN	Intel Centrino Wireless N2230/ IEEE WLAN Standard: 802.11b/g/n up to 300 Mbps/ 2.4 GHz/ Safety: WPA (TKIP)/ WPA2 (AES-CCMP)	
Bluetooth	Dual Mode Bluetooth 4.0 (low energy) 2.1, 2.1+EDR, 3.0, 3.0+HS, 4.0 (BLE)	
Can be combined with	with all front options	
Available for controller	IQ Atom, IQ Core-i	

Accessories

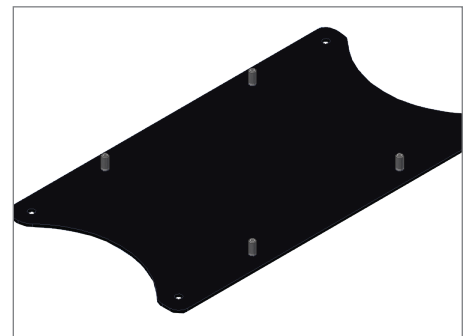
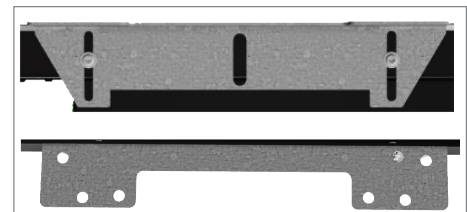

Order number	DS-91-797	DS-91-356
Name	VESA adapter plate	Mounting brackets
Description	Adaption from VESA 200 x 100 to VESA 100 x 100	Set of two additional mounting brackets
Can be combined with	with all front options	Open frame, front plate, safety glass, TrueFlat glass, PCAP touch, TrueFlat PCAP touch
Available for controller	all	

Power supply

Order number	NT-01-060	NT-01-061
Name	Power supply 60 W	Power supply 84 W
Description	12V/ 5A power supply max. op. temperature 45°C	12V/ 7A power supply max. op. temperature 40°C
Can be combined with	Video PME, VideoPoster, IQ Atom	Core-i5, Core-i7
Power cord EU 1,8 m	DB-07-225	
Power cord UK 1,8 m	DB-07-226	
Power cord USA 1,8 m	DB-07-238	

Operating systems, Software

Product	Order no.	Product description
Windows 7 embedded 32 bit DE	DS-60-645	Operation system
Windows 7 embedded 32 bit EN	DS-60-650	Operation system
Windows 7 FES 64 bit DE	DS-60-725	Operation system
Windows 7 FES 64 bit EN	DS-60-781	Operation system
Windows 8.1 embedded 64 bit DE	DS-60-764	Operation system
Windows 10 Pro. 64 bit DE	DS-60-811	Operation system
Windows 10 Pro. 64 bit EN	DS-60-810	Operation system
WEBPOStER	DS-60-787	WEBPOStER embedded Linux

Various accessories are available for POS-Line monitors.

All monitors can be customized according to your specific requirements.

Please contact our sales team if you are interested in product modifications or custom designs.

Data Display Group



DATA Display Group is represented through its own subsidiaries in Germany, the USA and England. Please address all enquiries to the office nearest to you. For sales or service matters we will either handle your enquiry directly, or invite you to contact one of our business partners in your area for assistance.

Distec GmbH
Augsburger Str. 2b
82110 Germering

+49 89 894363-0
 info@datadisplay-group.de
 www.datadisplay-group.de

Distec GmbH
Am Künkelhof 4
99820 Hørselberg-Hainich

+49 3 69 20 71 62-0

Display Technology Ltd.
5 The Oaks Business Village
Revenge Road, Lordswood
Chatham, Kent, ME5 8LF

+44 1634 672755
 info@displaytechnology.co.uk
 www.displaytechnology.co.uk

Apollo Display Technologies, Corp.
87 Raynor Avenue, Unit 1
Ronkonkoma, NY 11779

+1 631 5804360
 info@apolloDisplays.com
 www.apolloDisplays.com

Contact



All figures are typical values. The real values of the panel may vary. The optical characteristics are determined after the panel has been „ON“ for approximately 30 minutes at an ambient temperature of 25° C (77° F).

Life time of the backlight is defined as the time to take until the brightness reduces to 50% of its original value.

Copyright 2016 Data Display Group. Information in the document is subject to change without prior notice.